

THE NEW  
TWO-AXIS  
PRODUCT FAMILY

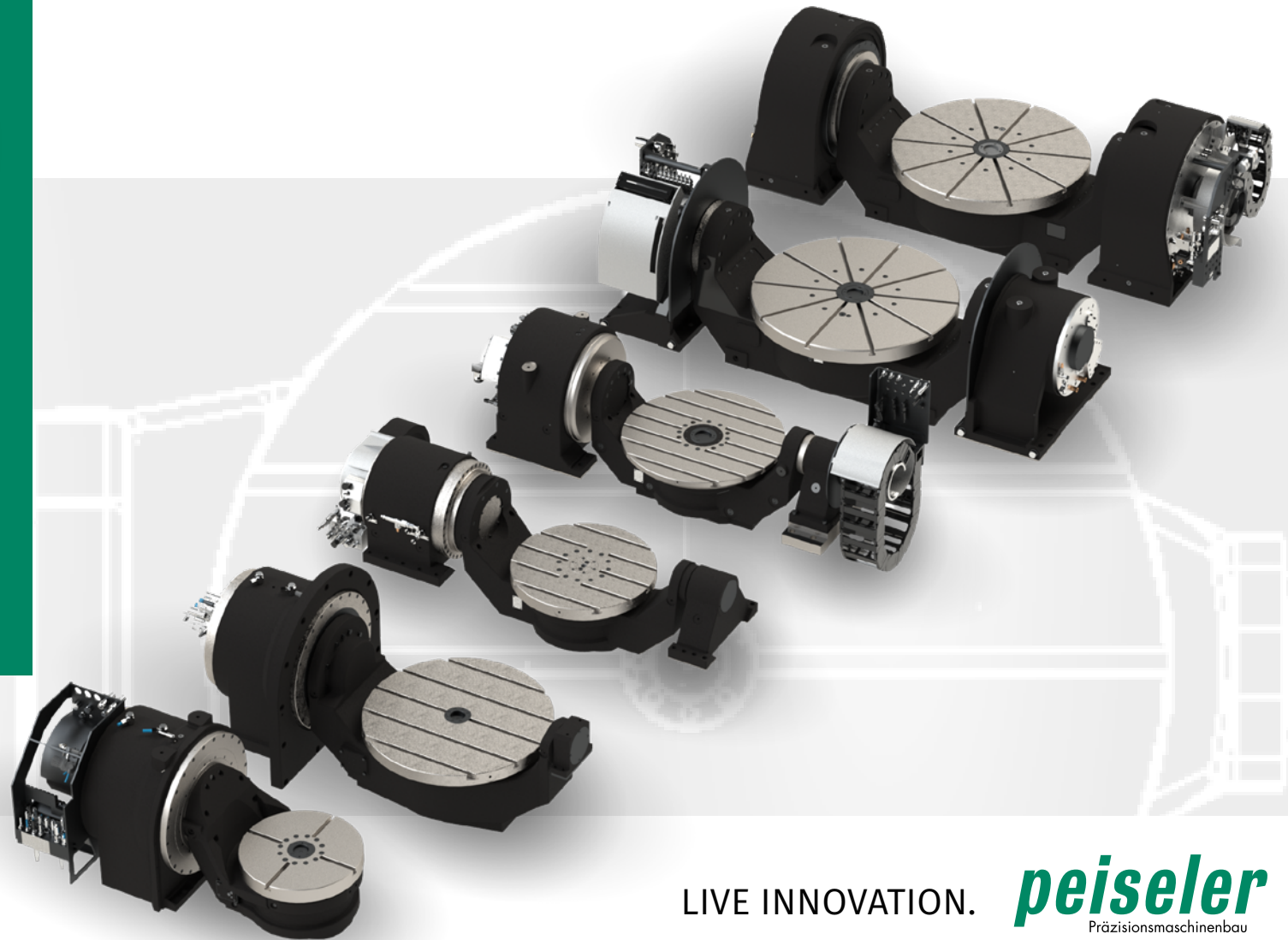

LIVE INNOVATION. **peiseler**  
Präzisionsmaschinenbau

# THE ZASD FAMILY

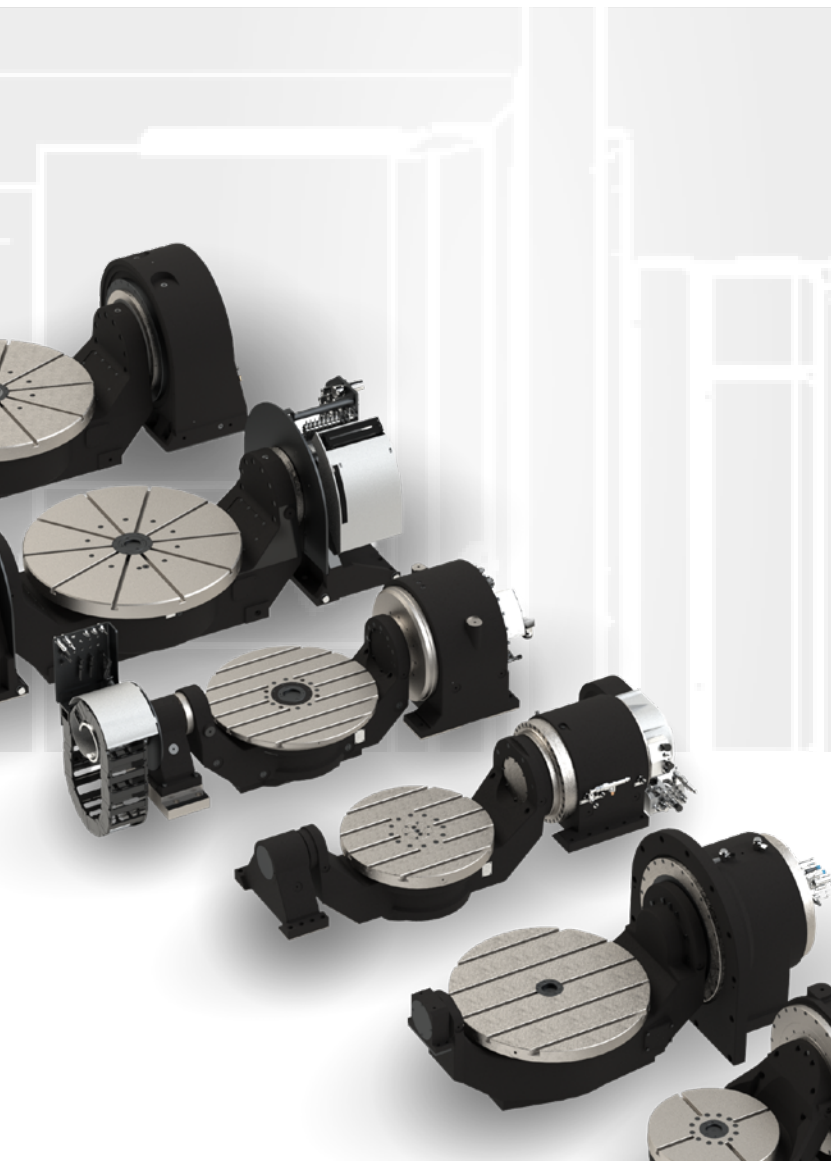

		ZASD 280		ZASD 320		ZASD 320	
Ø Faceplate diameter	mm	410		650		520	
Load capacity	kg	250		350		500	
Swivel range A-axis	°	± 120		± 110		+ 140/- 60	
Unit weight	kg	≈ 700		≈ 900		≈ 550	
Axis		A axis	C axis	A axis	C axis	A axis	C axis
System accuracy	"	± 2	± 2	± 2	± 5	± 5	± 5
Max. clamping torque	Nm	2,400	1,800	3,200	1,400	2,000	1,800
Max. continuous torque	Nm	900	250	1,200	400	1,000	400
Max. speed milling	rpm	60	100	60	100	100	100
Cont. speed millturn*	rpm	-	1,500	-	1,500	-	1,500

\*Reduced payload

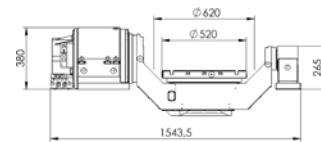
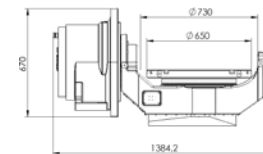
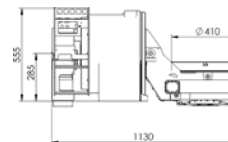



ZASD 320		ZASG 400		ZASD 400			
600		800		800		mm	Ø Faceplate diameter
600		850		850		kg	Load capacity
± 120		± 130		± 130		°	Swivel range A-axis
≈ 680		≈ 1400		≈ 2000		kg	Unit weight
A axis	C axis	A axis	C axis	A axis	C axis		Axis
± 5	± 5	± 5	± 5	± 5	± 5	"	System accuracy
4,000	2,000	3,360	3,000	2 x 3,000	3,000	Nm	Max. clamping torque
1,000	750	3,000	1,417	2 x 1,417	1,417	Nm	Max. continous torque
100	100	50	100	75	100	rpm	Max. speed milling
-	1,500	-	1,200	-	1,200	rpm	Cont. speed millturn*

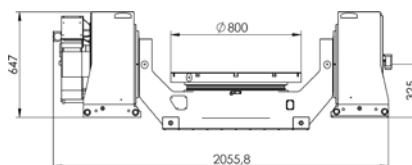
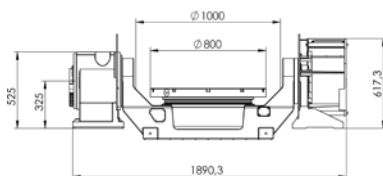
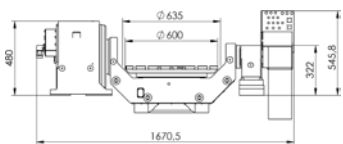

Our products are  
**MADE IN GERMANY**



[www.peiseler.de/en](http://www.peiseler.de/en)

**REDUCED HEAT INPUT**

- ✓ Reduced power loss\*
- ✓ Reduced thermal impact

**DURABLE COMPONENTS**

- ✓ Durable Peiseler rotary distributors & clamping systems

**OPTIMIZED DYNAMICS**

- ✓ DD motor as milling and MillTurn variant

**REDUCED TOTAL COST OF OWNERSHIP**

- ✓ Significant reduction of input torque\*
- ✓ Downsizing of drive components
- ✓ Reduced footprint of the control cabinet

\*compared to Peiseler ZASD 400

**SIMPLE SERVICE**

- ✓ Good accessibility of the components

**RETHINKING THE DRIVETRAIN**

- ✓ Compact coaxial gear unit with integrated bearing concept
- ✓ high-torque DD motor and absolute measuring system
- ✓ Zero backlash paired with high torsional stiffnesses
- ✓ Spring-actuated active safety clamping system

**REDUCED OWN WEIGHT**

- ✓ Significant weight saving of 26% or 600kg\*
- ✓ Higher dynamics possible when used on linear axis

**PEISELER TWO-AXIS SWIVELING DEVICES**

Whether you are performing 5-axis milling, simultaneous machining or turn-mill operations, Peiseler offers the ideal solution for every need and application with the ZASD series of high-torque direct drives. The newly designed drive train of the ZASG series combines an innovative concept of torque motor and a torsionally stiff as well as backlash-free coaxial gearbox and offers an optimal price-performance ratio of the overall machine. Perfect for 5-axis machining of e.g. structural components.

**ZASG 400**

**ENSURE  
COMPETITIVENESS.**

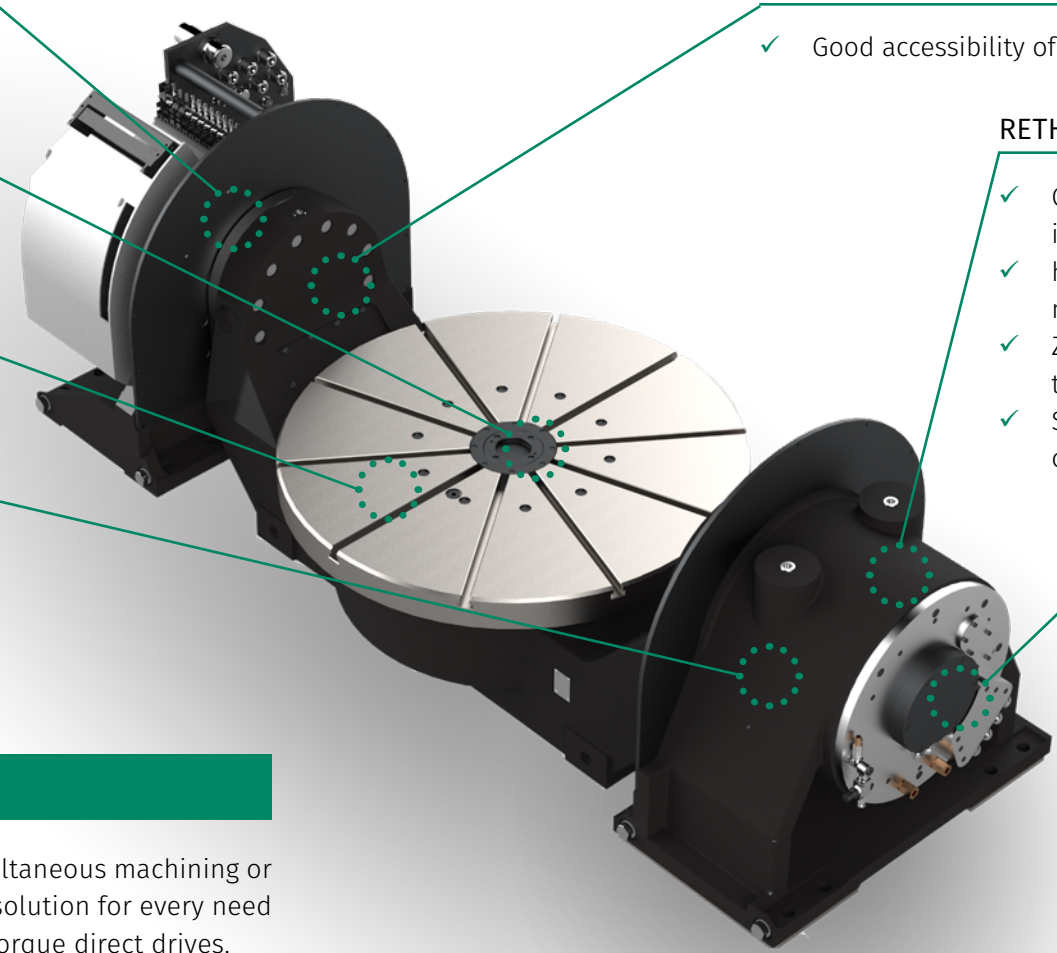



## MASTERING SIMULTANEOUS MACHINING

- ✓ Direct drives optimized for continuous torque
- ✓ High power density and optimized cooling concept
- ✓ High precision direct measuring systems

## PRECISE POSITIONING

- ✓ Axial-radial bearings ensure maximum precision and rigidity

## REDEFINING STRUCTURE

- ✓ Thermally stable design
- ✓ FEM optimized one-piece housing

## DRIVETRAIN RETHOUGHT

- ✓ Innovative engine cooling concept
- ✓ Powerful direct drive motors

		SSK 400	
Ø Spindle mount	mm	230	
A-axis swivel angle	°	±110	
Unit weight	kg	840	
Axis		A axis	C axis
System accuracy	"	± 2	± 3.5
Max. clamping torque	Nm	3,600	3,000
Max. continuous torque	Nm	852	635
Max. rotation	rpm	60	60

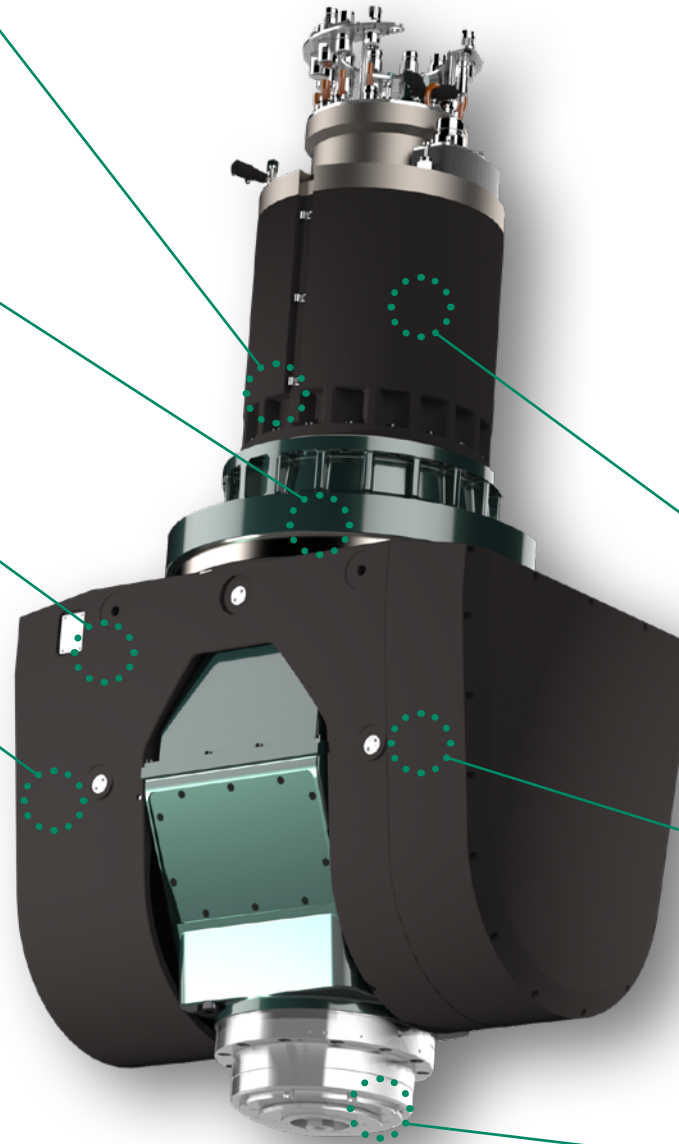

## PEISELER FORK MILLING HEADS

The 2-axis swivel heads of the SSK series offer the highest positioning accuracy and rigidity thanks to a newly conceived structural design. The innovative motor concept reliably conducts the waste heat out of the machining area and allows previously unattained power density in this installation space.

You select the spindle to be installed according to your machining requirements. We design the necessary interfaces in coordination with you and the spindle manufacturer.

## LIVE QUALITY

- ✓ Proven Peiseler components combined in a new way
- ✓ Reliable rotary distributors & low maintenance components

## STRONG CLAMPING SYSTEM

- ✓ Responsive active clamping
- ✓ Designed for use in harsh conditions
- ✓ Booster function for high holding torques in the heaviest machining tasks

## HIGHEST FLEXIBILITY

- ✓ Individualized spindle interfaces
- ✓ Manufacturer-independent configurable

# SSK 400

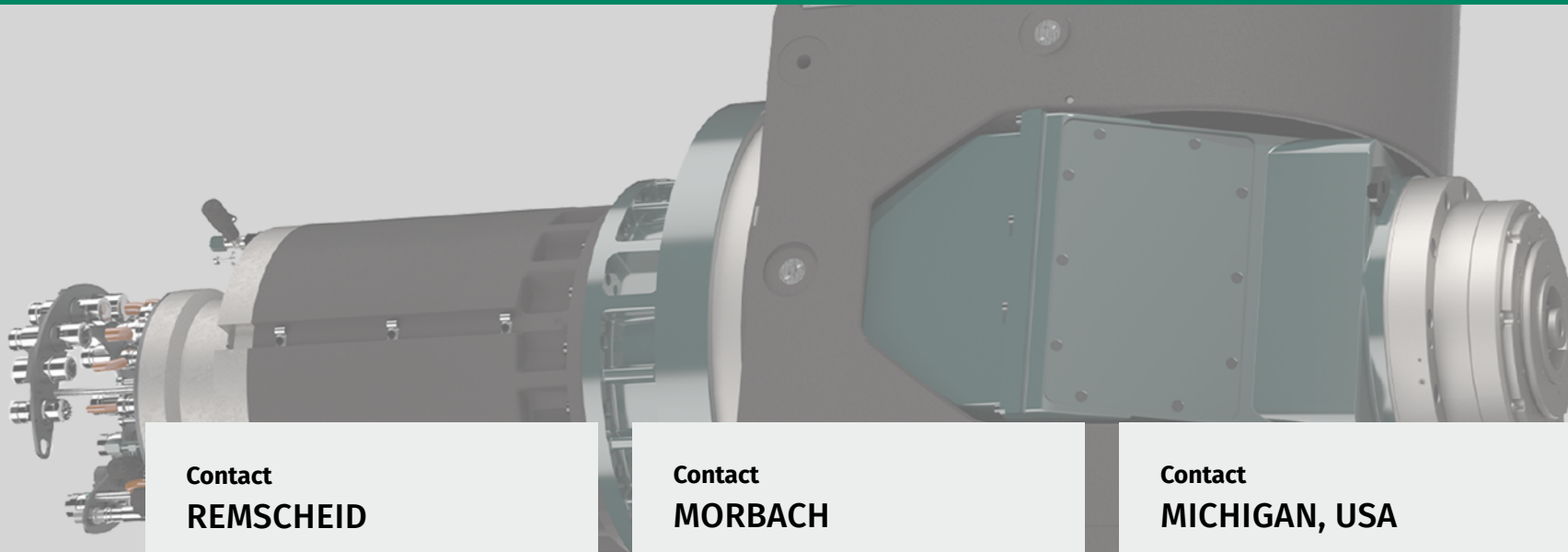

**Contact**

**REMSCHIED**

Peiseler GmbH & Co. KG

Morsbachtalstraße 1 u. 3

D- 42855 Remscheid

Phone: +49 (0) 2191 - 913 0

Telefax: +49 (0) 2191 - 913 164

Email: peiseler.rs@peiseler.de

**Contact**

**MORBACH**

Peiseler GmbH & Co. KG

Industriestraße 4

D- 54497 Morbach

Phone: +49 (0) 6533 - 950 10

Telefax: +49 (0) 6533 - 950 117

Email: peiseler.rs@peiseler.de

**Contact**

**MICHIGAN, USA**

Peiseler LLC USA

Mr. John Schury

601 Crosby, N.W.

Grand Rapids MI 49504

Phone: +1 - 616-235-8460

Telefax: +1 - 616-235-8463

Email: johns@peiseler.us